

A world class  
integrated supplier  
of Automotive  
Components &  
Assemblies





Company Overview	03
Board of Directors & Management	08
Organization Structure	10
Group Revenue & New Business Won	11
Product Portfolio & Joint Ventures	15
After Market Business Highlights	23
Manufacturing and R&D Capabilities	26
Awards, CSR Activities & HR Initiatives	32
Financials	36

Made In India With Pride

Incorporated in  
**1983**



Global Supplier of  
**Automotive  
Components**



**14**  
Manufacturing  
Plants



Presence in  
**4 Continents**



Over **4,500**  
Employees



Strong in-house  
**R&D  
Capabilities**



Turnover (FY20)  
**INR 1,424 Cr**



All Automotive  
**Certifications**





**Preferred partner to OEMs**

Client engagement from concept to completion stage

Strong in-house R&D capabilities.

Long-established relationship with OEMs.

**Strategically located plants**

Proximity of its plants to the OEMs.

Just in time approach

Last Mile Connectivity for overseas customers

**4 decades of Execution Experience**

Excellence in engineering critical products.

Strong focus on product & process innovation.

**De-risked Business Model**

**Extensive product portfolio:**

- Passenger vehicles,
- Commercial / Off Road Vehicles
- 2 Wheelers
- System Suppliers

**Balanced business:**

Segments / Geography





## Vision



To be the preferred supplier to OEM's across the globe.



**E**

### ENTREPRENEURSHIP

The power of pursuing new challenges with speed, flexibility and ownership



**T**

### TEAMWORK

The power of working together



**I**

### INTEGRITY

The power of honesty and transparency



**C**

### COMMITMENT

The power of responsibility, accountability and ownership



**EX**

### EXCELLENCE

The power of being the best

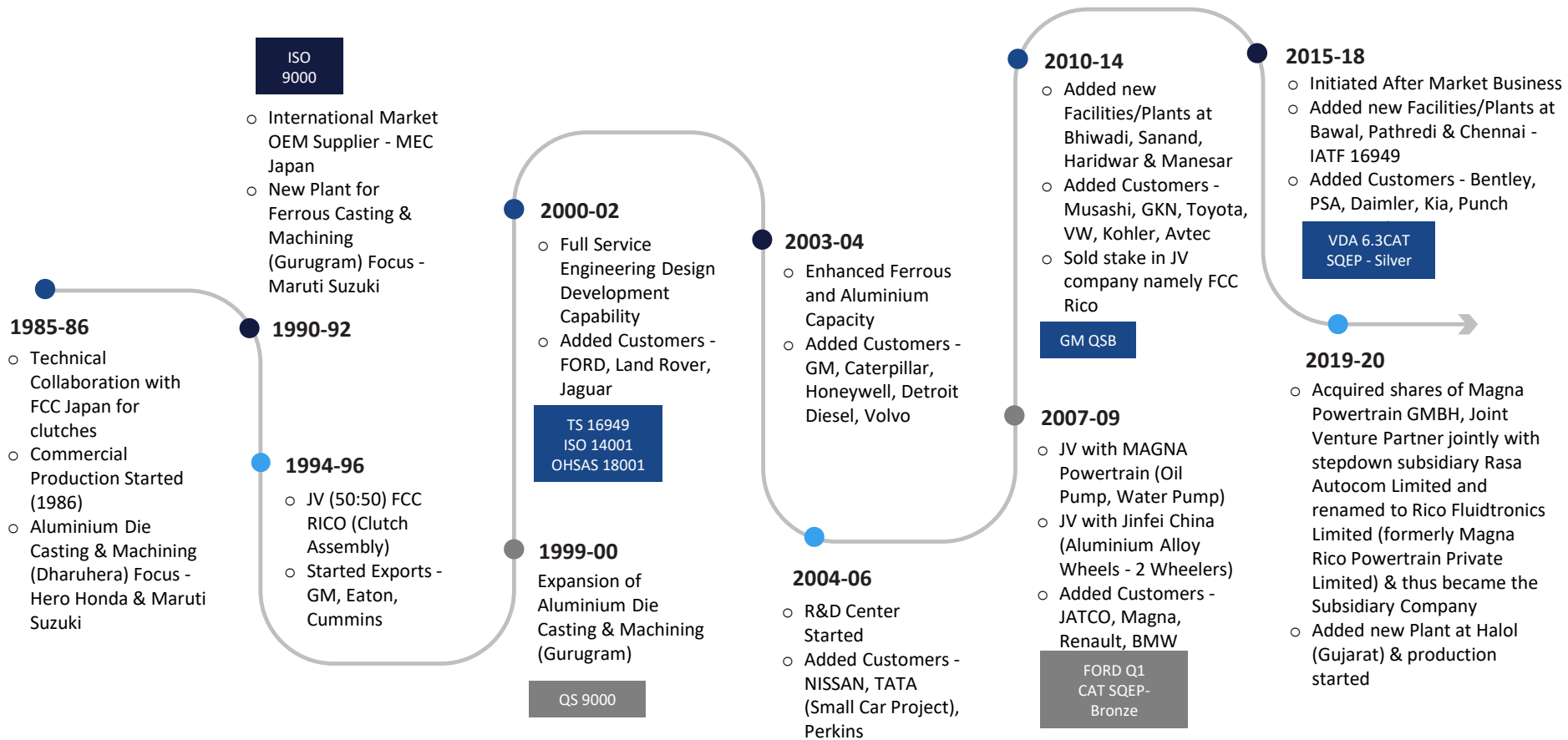

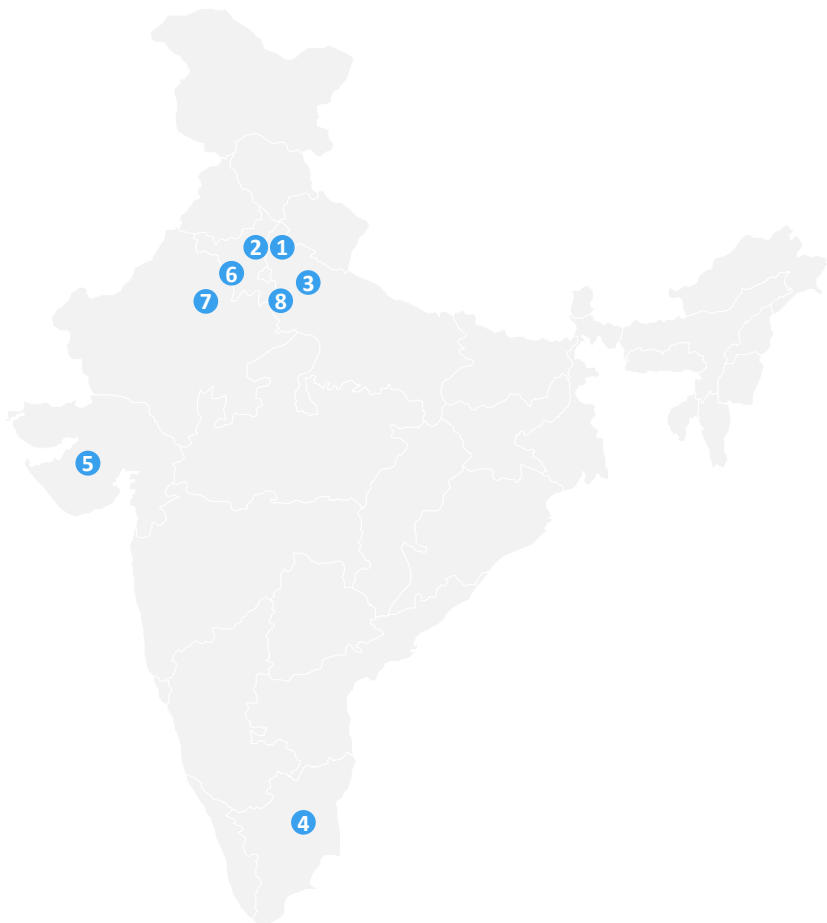

<p><b>1 GURGAON</b> 27 Acres</p>  <p>(Corporate, R&amp;D, Tool Manufacturing, Ferrous Casting, Al. HPDC, Machining)</p>	<p><b>2 BAWAL</b> 15 Acres</p>  <p>(Al. HPDC, Machining)</p>
<p><b>3 BHIWADI / PATHREDI</b> 12 Acres</p>  <p>(Machining)</p>	<p><b>4 CHENNAI</b> 12 Acres</p>  <p>(Al. HPDC, Machining)</p>
<p><b>5 SANAND</b> 5.5 Acres</p>  <p>(Al. HPDC, Machining)</p>	<p><b>6 DHARUHERA</b> 5 Acres</p>  <p>(Al. HPDC, Machining)</p>
<p><b>7 MANESAR</b> 5 Acres</p>  <p>(Al. GDC, Machining)</p>	<p><b>8 HARIDWAR</b> 2 Acres</p>  <p>(Al. HPDC, Machining)</p>



## Arvind Kapur

Chairman, CEO & Managing Director



### Kanwal Monga

Independent Director



### Amarjit Chopra

Independent Director



### Dr. Ashok Seth

Independent Director



### Satish Sekhri

Independent Director



### Rajeev Kapoor

Independent Director



### Vinod Kumar Nagar

Independent Director



### Upasana Kapur

Non-executive director



### Arun Kapur

Joint Managing Director







**Surendra Singh**  
President & COO



**Rakesh Sharma**  
Chief Financial Officer



**R. K. Miglani**  
Senior Vice President  
(Operations & Engineering)



**Kaushalendra Verma**  
Senior Vice President



**R. Dharna**  
Vice President Operations



**M. K. Jain**  
Chief Technical Officer



**S. Kaul**  
Vice President Operations



**Sandeep Rajpal**  
Vice President Marketing



**Abhishek Kulshrestha**  
Vice President  
(Procurement, Vendor Devp. & After  
Market.)



**Subodh Mal**  
Associate Vice President  
(Foundry & Tool Room)



**Rajiv Kumar**  
Associate Vice President  
( R & D / Engineering )



**Shalinder Rathi**  
Associate Vice President  
( HR & IR )

### Company Secretary

### Advisory Committee



**Sanjay Sharma**  
Chief General Manager  
(Corporate Quality Head)



**Neelam Dhaka**  
General Manager  
(Corporate Human Resources)



**B. M. Jhamb**  
Company Secretary



**N. K. Sethi**  
Management Advisor



**O. P. Aggarwal**  
Financial Advisor



## RICO RICO AUTO INDUSTRIES LIMITED

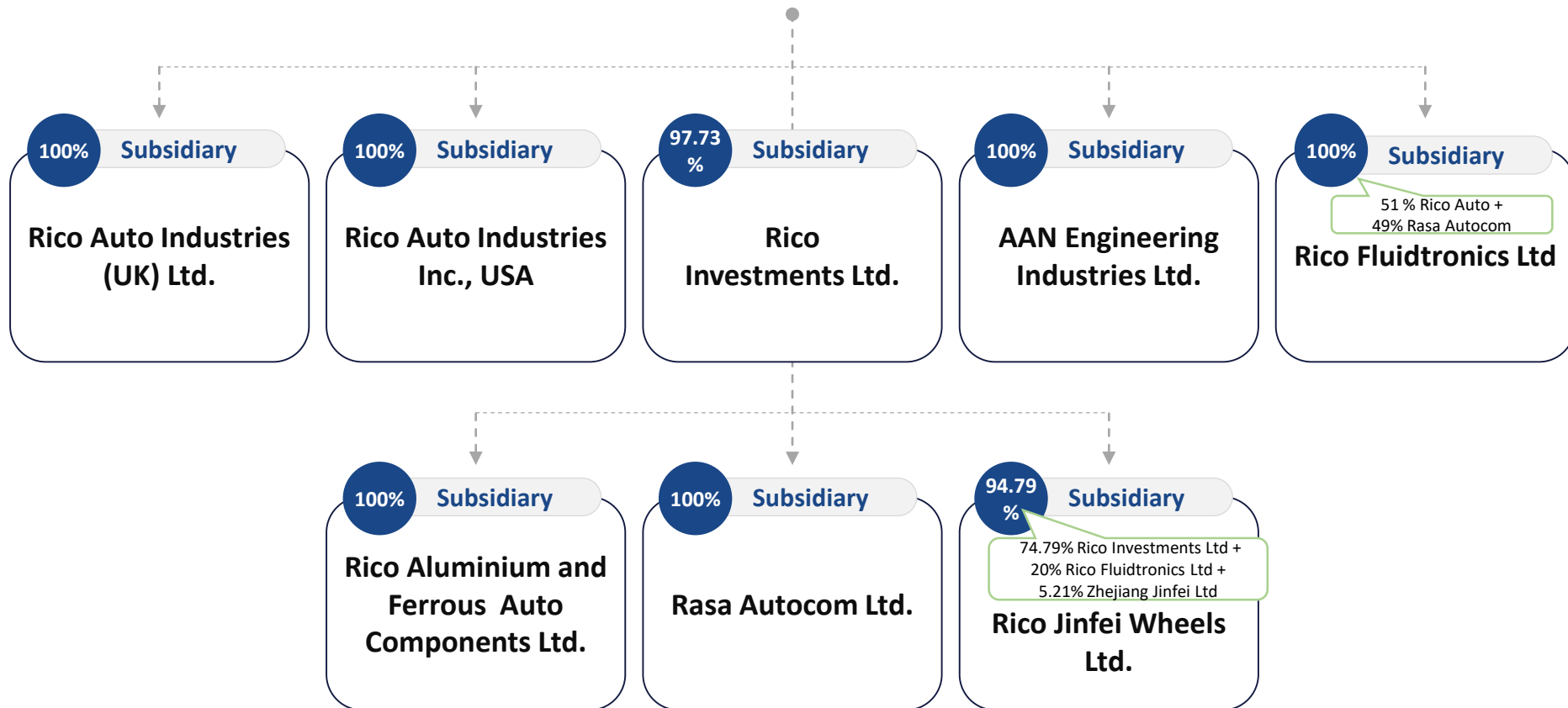

**FY 19 (Actual)**

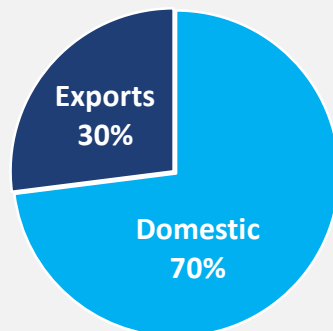
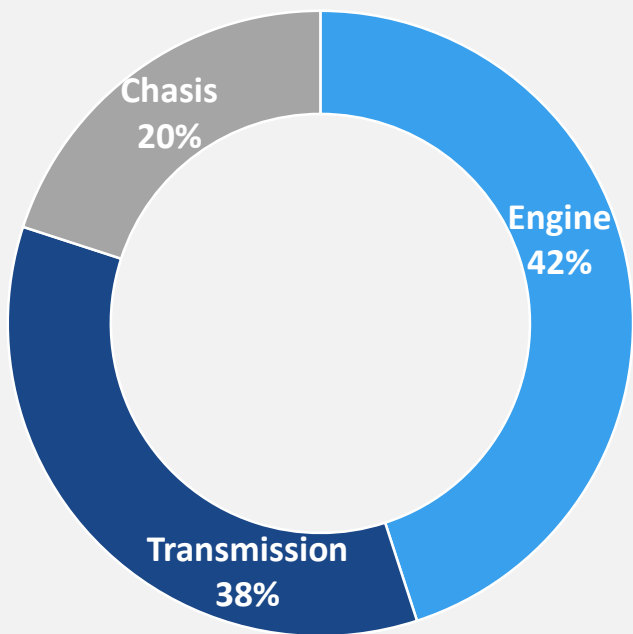

**FY 20 (Actual)**

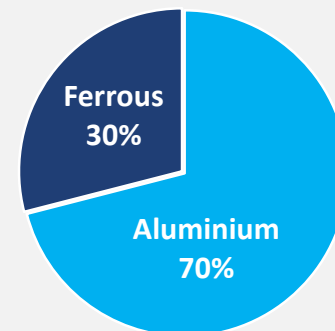
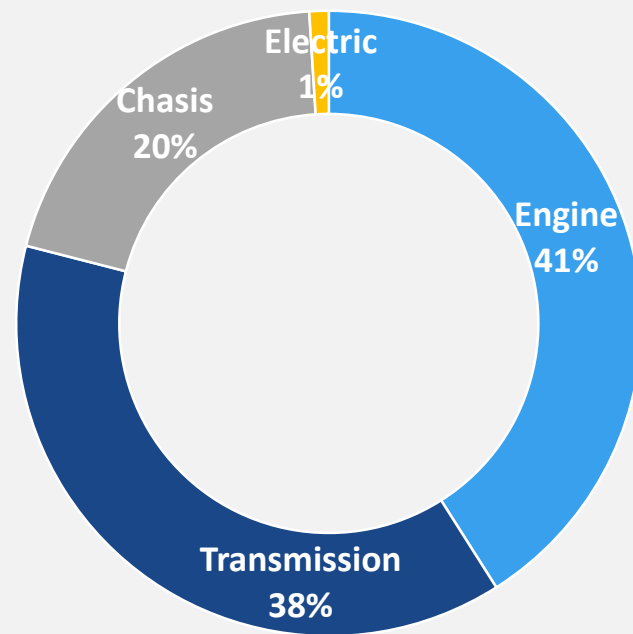



# New Customer Addition

Program Value  
**310 Cr**

Program Value  
**800 Cr**

Program Value  
**40 Cr**

Program Value  
**108 Cr**

Program Value  
**37 Cr**



DAIMLER

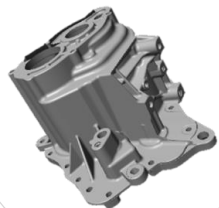
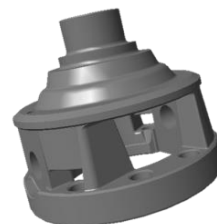
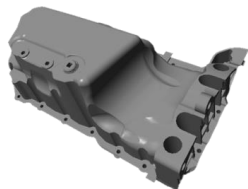
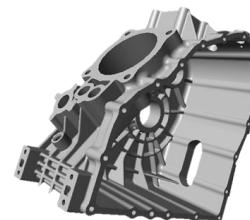
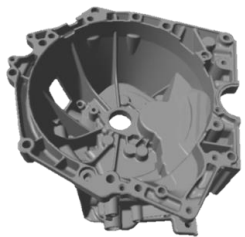

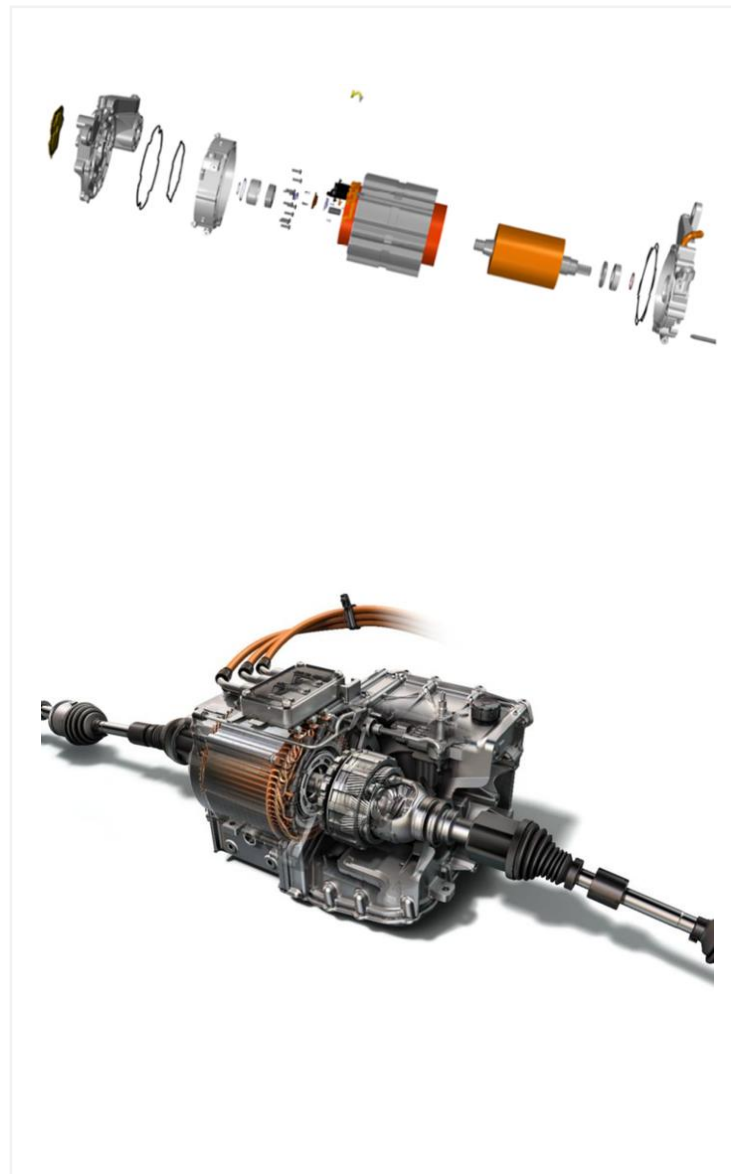
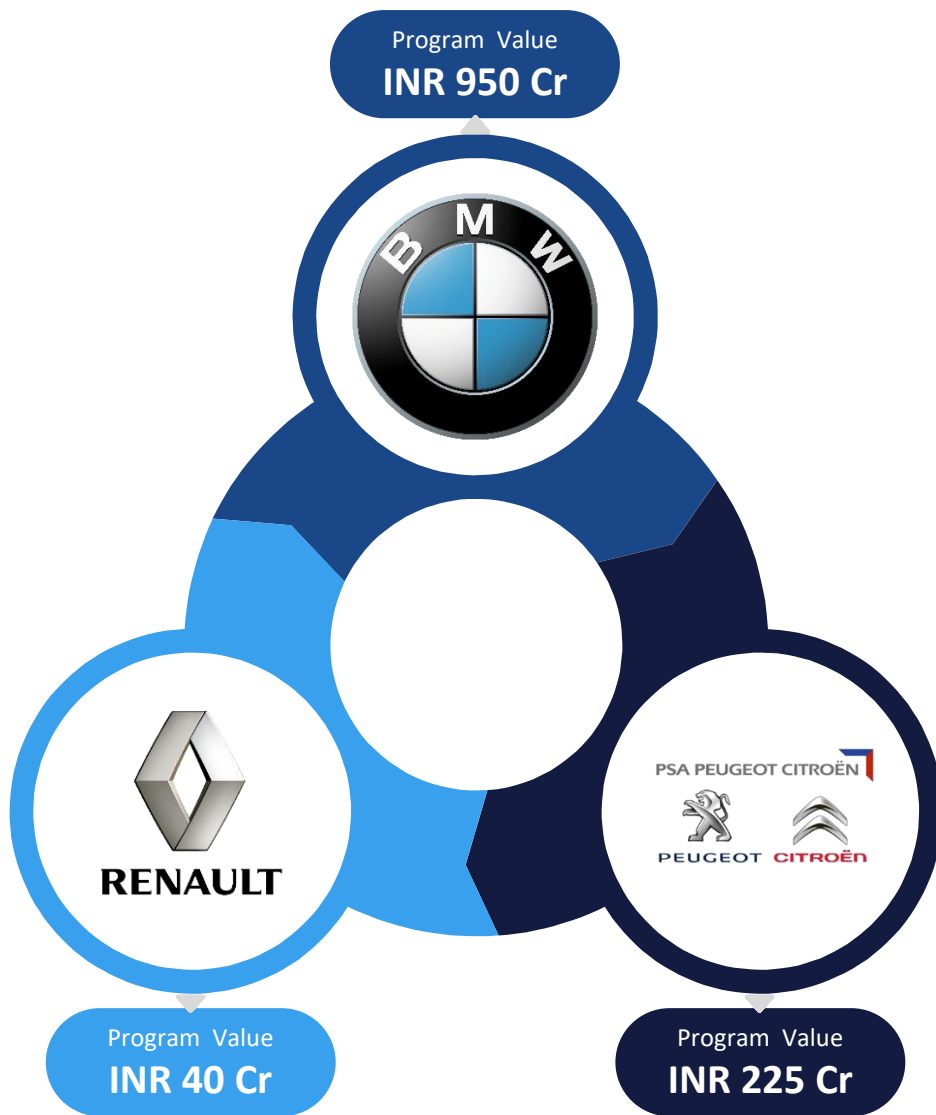

Program Value  
INR 1,200 Cr

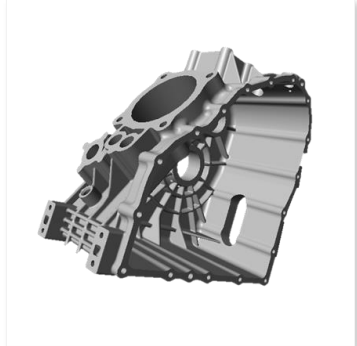

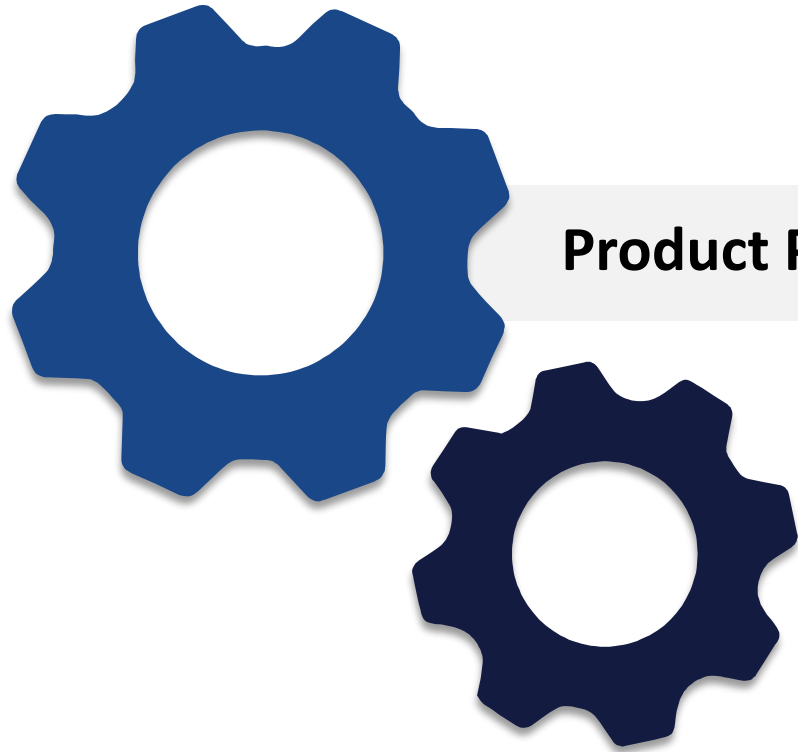

## Product Portfolio





**ALUMINUM CASTING**



**FERROUS CASTING**



**MACHINING AND ASSEMBLY**

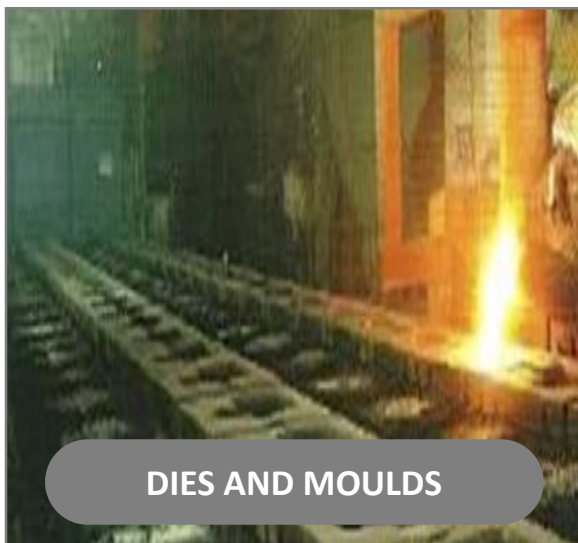

**DIES AND MOULDS**



**DEFENCE EQUIPMENTS**



**ENGINEERING & R&D**





Assy. Cover Cylinder Head



Balancer Shaft



Exhaust Manifold



Turbine/ Center Hsg



Engine Block

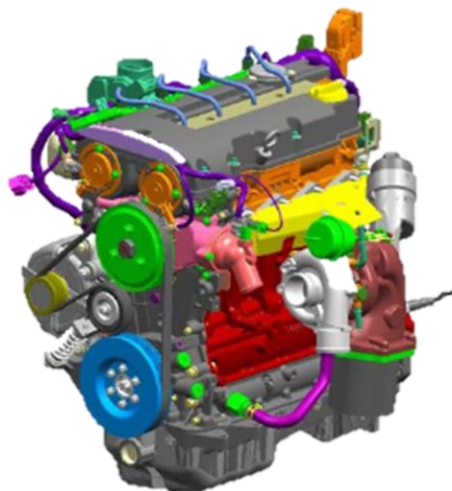

Case Chain/ Case Timing



Engine & Support Brackets

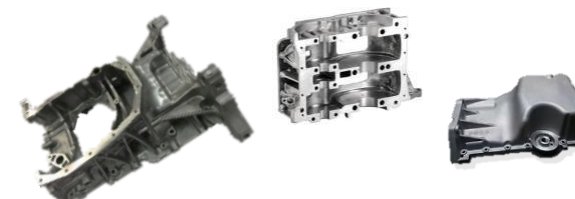

Oil Pan



Bearing Cap



Turbo Outlet



EGR Pipe

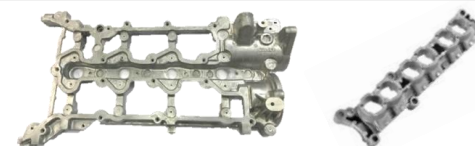

Cam Cap Support / Ladder Frame





Transmission Case



Clutch / Mechanical Housing

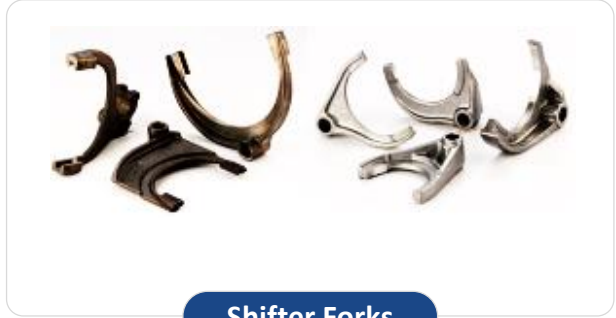

Shifter Forks



Front Diff Housing



Ground Sleeve & Shaft

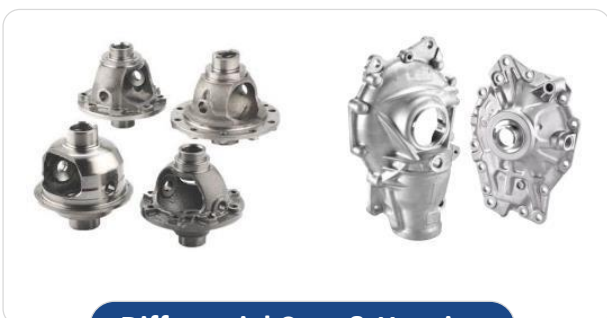

Differential Case & Housing



Retainer Bearing Support



Front & Rear Hubs



Front & Rear Brake Panel Assy



Crank Cases



CBS



Grips



Crank Cases

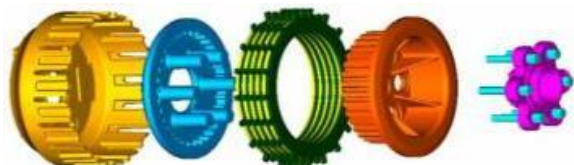

Clutch Assembly



Engine Cover



Alloy Wheels





Rico Fluidtronics Limited (Formally known as Magna Rico Powertrain Private Limited) has now become a subsidiary of Rico Auto Industries Limited. Rico Auto Industries Limited, along with its step down subsidiary, Rasa Autocom Limited holds the entire share capital of Magna Rico Powertrain Private Limited. The name of the company was subsequently changed to Rico Fluidtronics Limited.

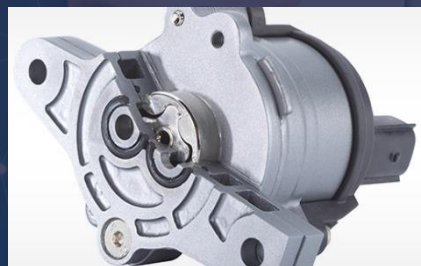

Oil Pump



Water Pump  
(Automotive Engines)  
(India & Europe)

Year	FY 17-18	FY 17-18	FY 19-20
Oil & Water Pump Assy ( Nos in Mn)	1.61	1.64	1.45
Turnover (INR Cr)	92.44	92.54	80.85

Client:





Year	FY 17-18	FY 18-19	FY 19-20
Alloy Wheels ( nos. in Mn )	1.10	1.27	1.14
Turnover ( INR Cr )	114.06	136.54	119.73

Client: \_\_\_\_\_



### Joint Venture

94.79% : 5.21%



Aluminum Alloy Wheels (Two Wheelers)

### Capacity Expansion

3 Mn

Dec 18





Year	FY 17-18	FY 18-19	FY 19-20
Turnover (INR CR)	4.1	4.2	1.96

## Client:



ECIL



OF Muradnagar



OF Khamaria



Prototype Tool Factory

## AAN Engineering Industries Ltd.



Aerial Ammunition 50 Cr spread in 3 years starting 2020

### Make In India Ammunition

- under bidding Dec 19
- 2500 Cr program value spread over for 10 years

### Make In India Electronic Fuse Assembly

- under bidding Dec 2019
- 3500 Cr program value spread over for 10 years

## Arms Licence for the Manufacturing of Ammunition

Track Link Assembly





## After Market Business Highlights





## Launch Of 4W Parts in FY19

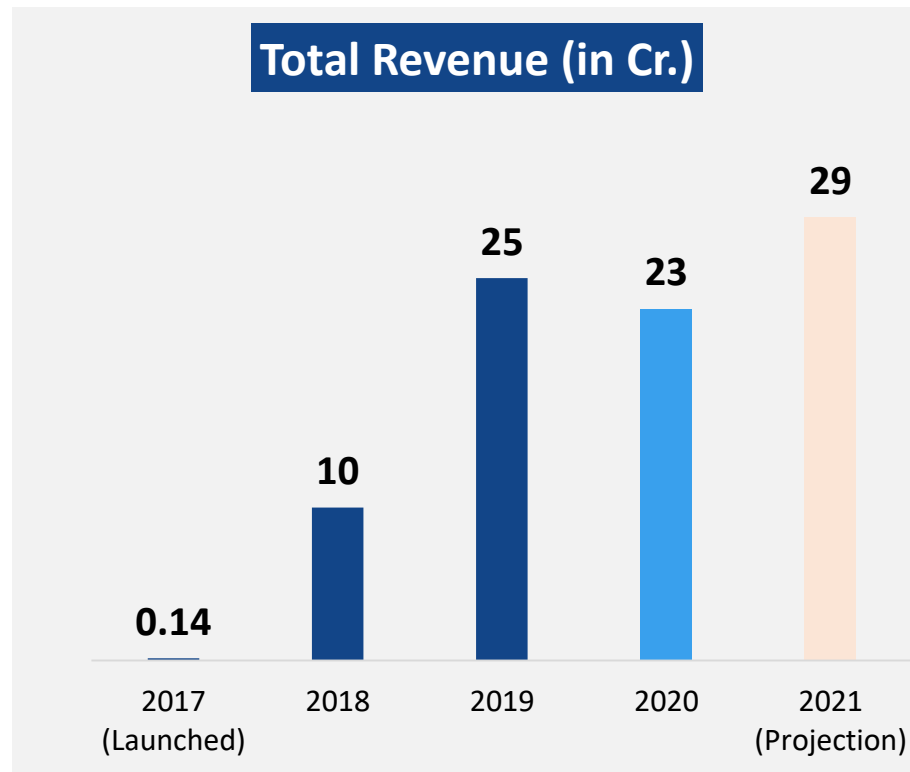

Initiated on  
**20<sup>th</sup> May'2017**

Product Range  
**2W, 4W & 3W**

**120 Dealers**  
(20+ States in India,  
Srilanka & Nepal)

Parts launched  
**580**







**WHEELS & BRAKING SYSTEMS**



**CLUTCH ASSEMBLY & COMPONENTS**

**New Products**



**LEVER**



**YOKE**



**CHAIN SPROCKET**



**CLUTCH HUB & CENTRE**



**INNER CLUTCH ASSEMBLIES**





## Manufacturing and R&D Capabilities

**Over 100 High Pressure Die Casting Machines  
(up to 2700 Tns Locking Force)  
Largest High Pressure Die Casting Capacity in India  
including GDC & LPDC.**





**4 Molding Lines - 2 DISA & 2 Horizontal (SINTO & DISA)  
Vertical Size ( 650 \* 535 \* 130~330) & Horizontal Size ( 610 \* 510 \* 200+200)  
Material: Gray (FC), Ductile (FCD), SiMo, SiMo Chrome**



Over **2,500** Machines (CNCs & SPMs)

One of the Largest Machining Facility in India

Over **50%** of Our Product Range is with Assemblies



**100 +**  
New Projects

**25**  
New Engineers added

Expansion of Engineering set  
up to Bawal & Chennai

Prototype Cell Created

Pool of machines & 3D  
Printing

Special Purpose CNC  
Machines Development

Concurrent Engineering

High Strength Aluminum Alloy

Structural Parts

Stainless Steel Turbine

Higher CC Clutch Segment

Automation in Casting &  
Machining lines

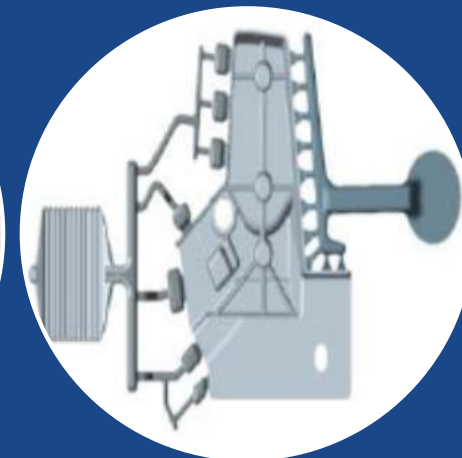



Combo. Brake System (CBS)  
Design and Test.  
Project Done with Customer  
as Associates .  
Now in Mass Production

Rico Design Clutch -100 cc  
Models for BS –VI.  
Now in Mass Production

Rico Design Clutch -110 cc  
Models for BS –VI.  
Now in Mass Production.  
–New Business for Rico

Rico Design Clutch -125 cc  
Models for BS –VI.  
Now in Mass Production.  
–New Business for Rico

Clutch Damping Characteristics  
Reliability Measurement and  
Test Equipment installed .  
For clutches

Development of Friction  
material –cork /Rubber type  
for Clutches.  
Completed –under mass  
production

Special paper deign and  
development for clutches  
Under process.  
Target –Qtr-1-2021

CVT Development for  
scooters is under  
Development .  
Will be New segment .  
Target –Qtr-1-2021

CBS

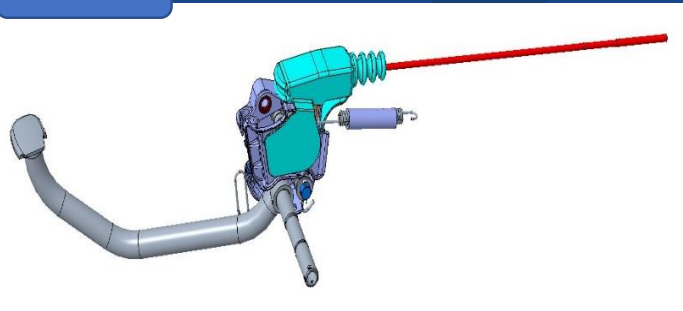

CLUTCH ASSY.

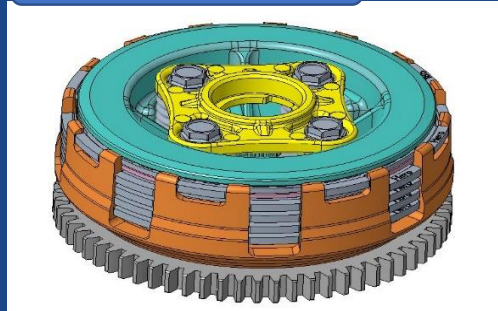

CVT ASSY.

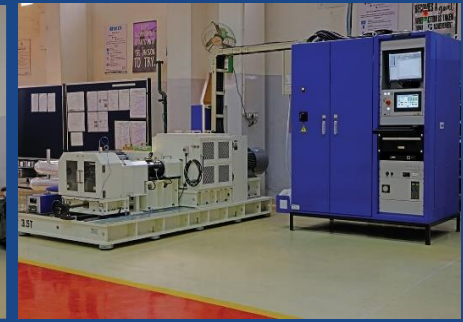
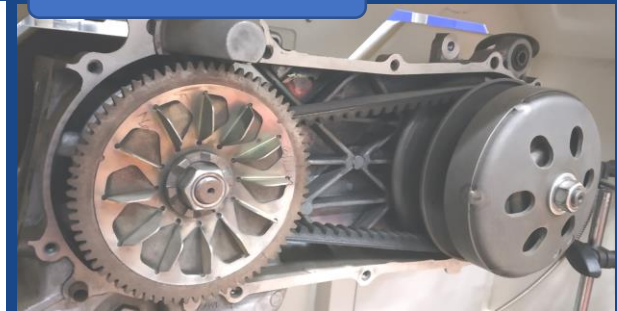



## **Awards, CSR Activities & HR Initiatives**



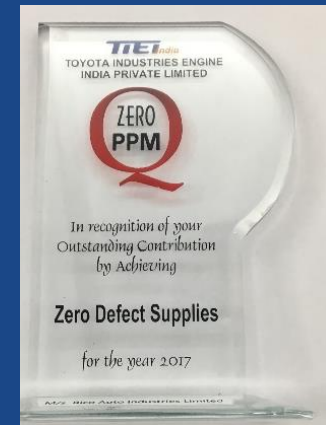
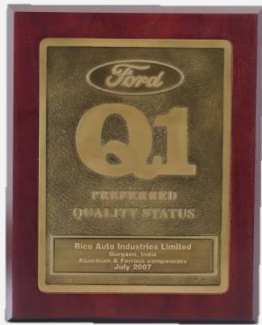





Company Wide Training – “Jagriti”



Kaizen Award Ceremony



Best Work Place - Competition



Family Connect Program



Employees Children Safety Competition



Sports Competition



Yoga Training



Health Awareness Camp





## Financials



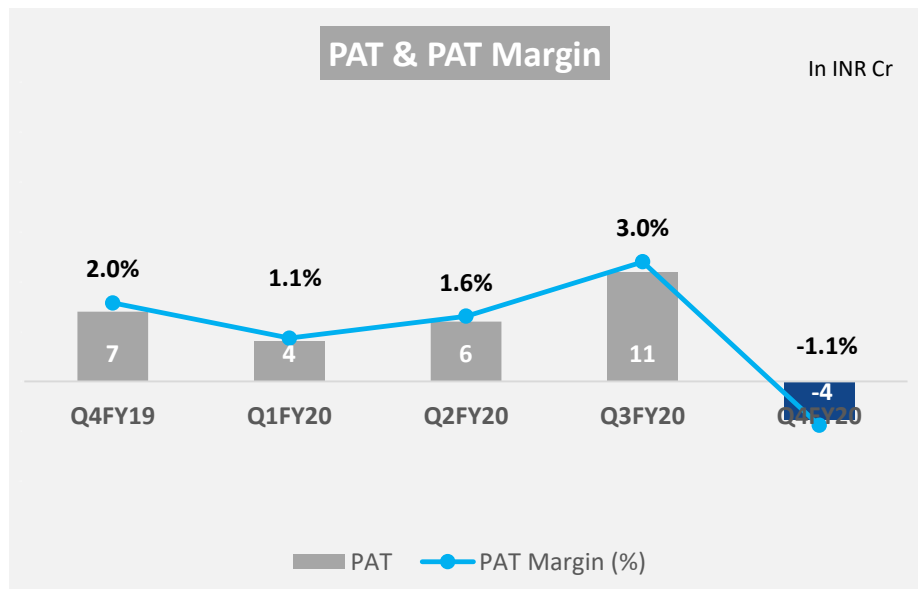
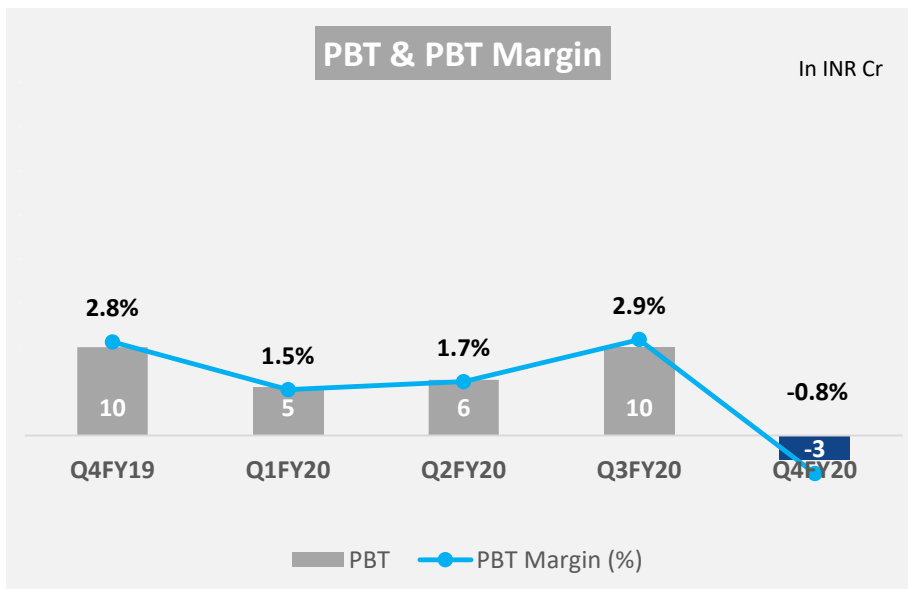
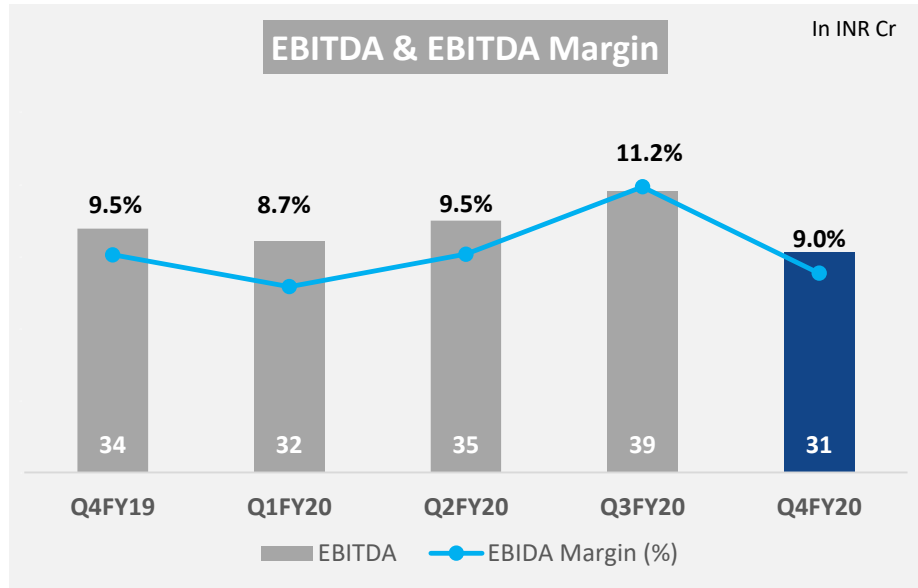
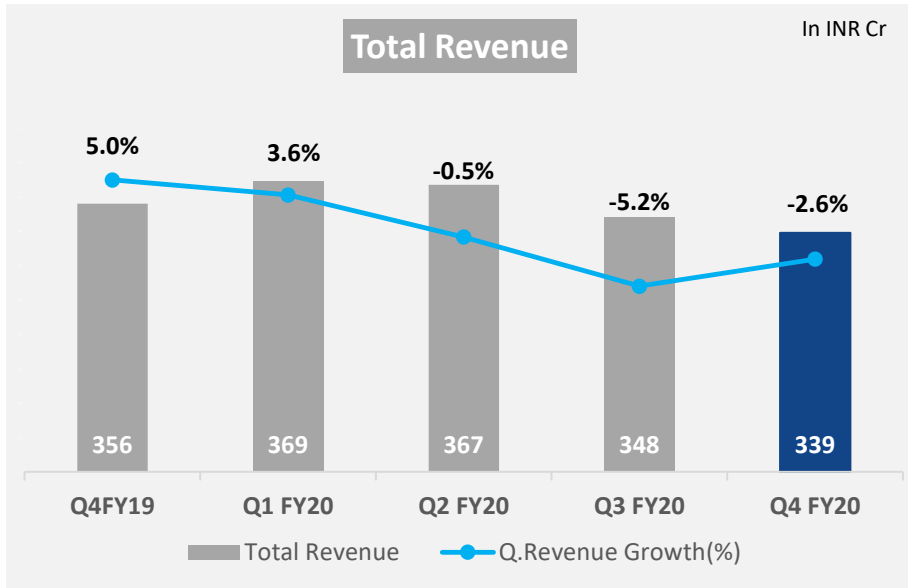

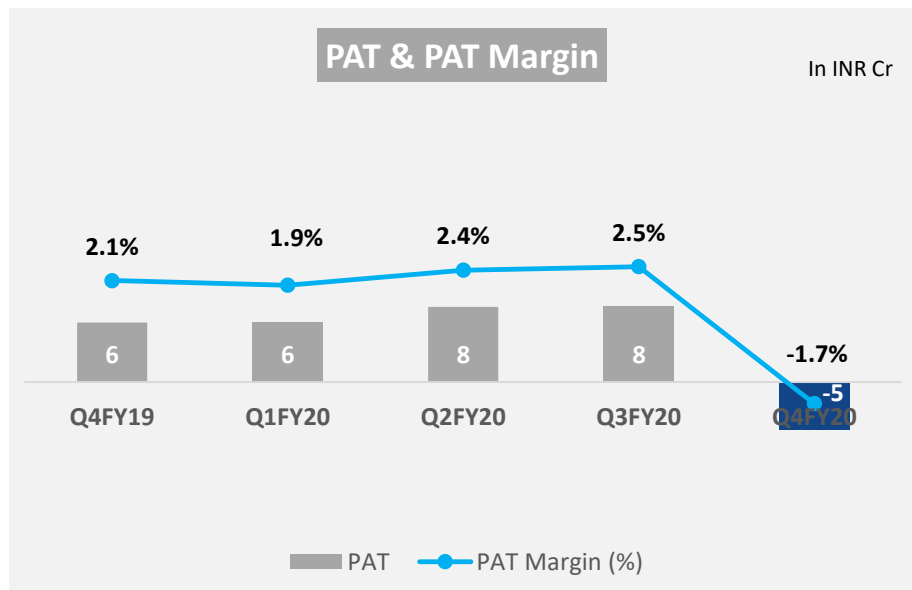
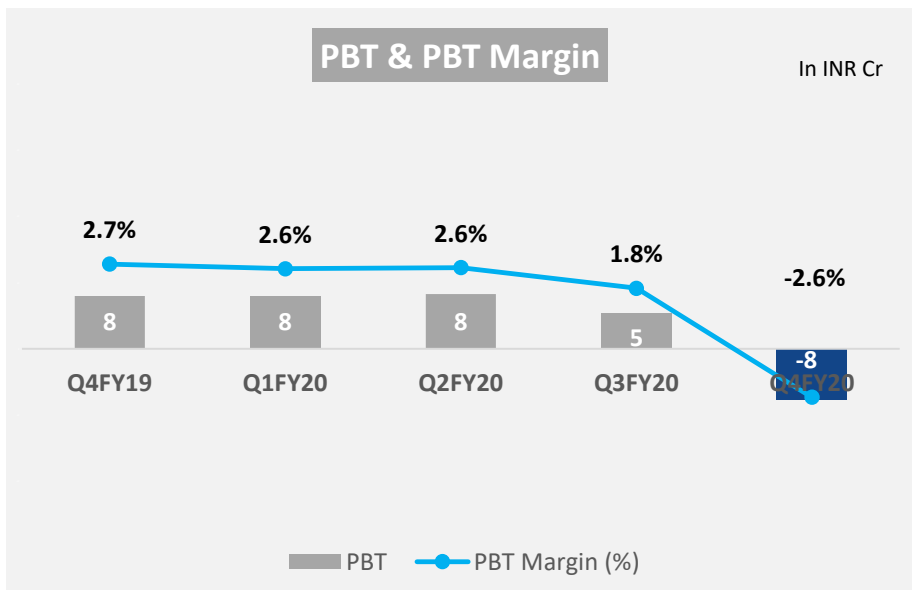
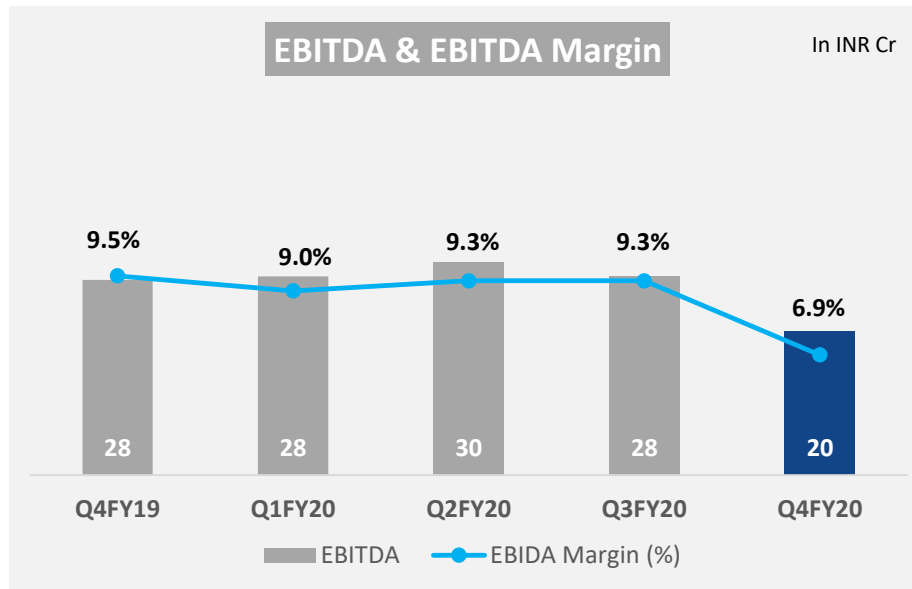
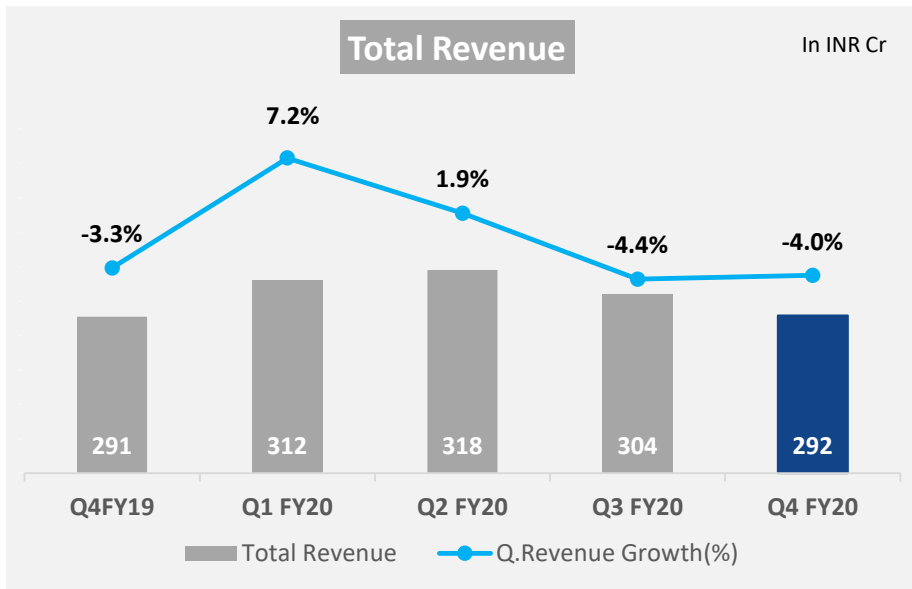



In INR Cr Standalone			Consolidated In INR Cr			
Q4FY20	Q4FY19	Chg YoY(%)	Particulars	Q4FY20	Q4FY19	Chg YoY(%)
281.41	282.75	-0.5%	<b>Operating Revenue</b>	330.71	347.76	-4.9%
10.34	8.18		Other Income	8.55	8.28	
291.75	290.93	0.3%	<b>Total Revenue</b>	339.26	356.04	-4.7%
295.12	282.34	4.5%	<b>Total Expenses</b>	337.7	346.11	-2.4%
175.65	187.38		Cost of Materials consumed	168.8	195.24	
38.28	32.06		Other Manufacturing and operating Expenses	64.77	63.8	
30.01	27.37		Employee benefit expenses	42.01	39.45	
8.18	7.85		Finance Cost	9.11	8.84	
15.39	11.09		Depreciation	19.95	14.59	
27.61	16.59		Other Expenses	33.06	24.19	
20.2	27.53	-26.6%	<b>EBITDA</b>	30.62	34.36	-10.9%
6.9%	9.5%		EBITDA Margin	9.0%	9.7%	
			Profit from JV		1	
4.25	0.4		Exceptional items	4.38	0.50	
-7.62	8.19	-193.0%	<b>PBT</b>	-2.82	10.43	-127.0%
-2.6%	2.8%		PBT (Margin)	-0.8%	2.9%	
-2.80	2.48		Tax	1.02	3.58	
-4.82	5.71	-184.4%	<b>PAT</b>	-3.84	6.85	-156.1%
-1.7%	2.0%		PAT (Margin)	-1.1%	1.9%	
-0.36	0.42		<b>EPS (Rs.)</b>	-0.3	0.49	





In INR Cr Standalone				Consolidated In INR Cr		
Q4FY20	Q3FY20	Chg QoQ(%)	Particulars	Q4FY20	Q3FY20	Chg QoQ(%)
281.41	296.33	-5.0%	<b>Operating Revenue</b>	330.71	342.38	-3.4%
10.34	7.79		Other Income	8.55	5.94	
291.75	304.12	-4.1%	<b>Total Revenue</b>	339.26	348.32	-2.6%
295.12	298.47	-1.1%	<b>Total Expenses</b>	337.7	338.03	-0.1%
175.65	185.21		Cost of Materials consumed	168.8	172.44	
38.28	35.13		Other Manufacturing and operating Expenses	64.77	62.42	
30.01	30.61		Employee benefit expenses	42.01	43.92	
8.18	6.95		Finance Cost	9.11	7.82	
15.39	15.68		Depreciation	19.95	20.73	
27.61	24.89		Other Expenses	33.06	30.7	
20.2	28.28	-28.6%	<b>EBITDA</b>	30.62	38.84	-21.2%
6.9%	9.3%		EBITDA Margin	9.0%	11.2%	
			Profit from JV		-	
4.25	0.24		Exceptional items	4.38	0.35	
-7.62	5.41	-240.9%	<b>PBT</b>	-2.82	9.94	-128.4%
-2.6%	1.8%		PBT (Margin)	-0.8%	2.9%	
-2.80	-2.15		Tax	1.02	-0.68	
-4.82	7.56	-163.8%	<b>PAT</b>	-3.84	10.62	-136.2%
-1.7%	2.5%		PAT (Margin)	-1.1%	3.0%	
-0.36	0.56		<b>EPS (Rs.)</b>	-0.3	0.78	





In INR Cr			Consolidated			
Standalone			In INR Cr			
FY20	FY19	Chg YoY(%)	Particulars	FY20	FY19	Chg YoY(%)
<b>1192.73</b>	<b>1,195.89</b>	<b>-0.3%</b>	<b>Operating Revenue</b>	<b>1401.07</b>	<b>1,392.65</b>	<b>0.6%</b>
33.54	28.61		Other Income	22.71	19.41	
<b>1226.27</b>	<b>1,224.50</b>	<b>0.1%</b>	<b>Total Revenue</b>	<b>1423.78</b>	<b>1,412.06</b>	<b>0.8%</b>
<b>1207.41</b>	<b>1,148.94</b>	<b>5.1%</b>	<b>Total Expenses</b>	<b>1398.09</b>	<b>1333.49</b>	<b>4.8%</b>
762.82	791.16		Cost of Marterials consumed	740.53	744.93	
143.15	118.14		Other Manufacturing and operating Expenses	256.17	253.33	
119.18	105.46		Employee benefit expenses	171.9	152.91	
27.18	23.14		Finance Cost	31.2	26.79	
59.96	43.83		Depreciation	79.57	57.7	
95.12	67.21		Other Expenses	118.72	97.83	
106	142.53	<b>-25.6%</b>	<b>EBITDA</b>	136.46	166.22	<b>-17.9%</b>
<b>8.6%</b>	<b>11.6%</b>		EBITDA Margin	<b>9.6%</b>	<b>11.8%</b>	
			Profit from JV		3.16	
5.21	9.13		Exceptional items	6.79	9.60	
13.65	66.43	<b>-79.5%</b>	<b>PBT</b>	18.90	72.13	<b>-73.8%</b>
1.1%	5.4%		PBT (Margin)	1.3%	5.1%	
<b>-2.93</b>	<b>17.67</b>		Tax	<b>2.22</b>	<b>21.1</b>	
16.58	48.76	<b>-66.0%</b>	<b>PAT</b>	16.68	51.03	<b>-67.3%</b>
<b>1.4%</b>	<b>4.0%</b>		PAT (Margin)	<b>1.2%</b>	<b>3.6%</b>	
<b>1.23</b>	<b>3.6</b>		<b>EPS (Rs.)</b>	<b>1.23</b>	<b>3.73</b>	

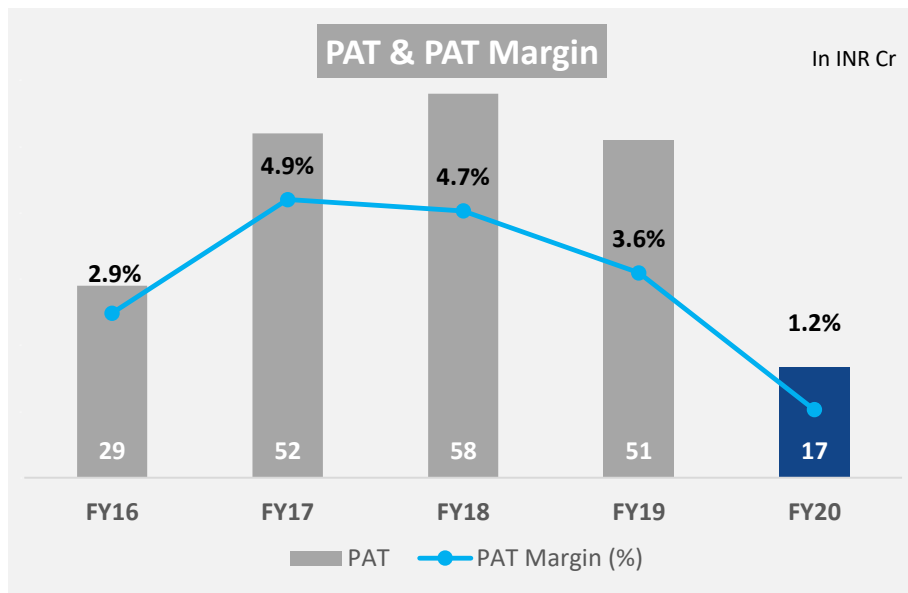
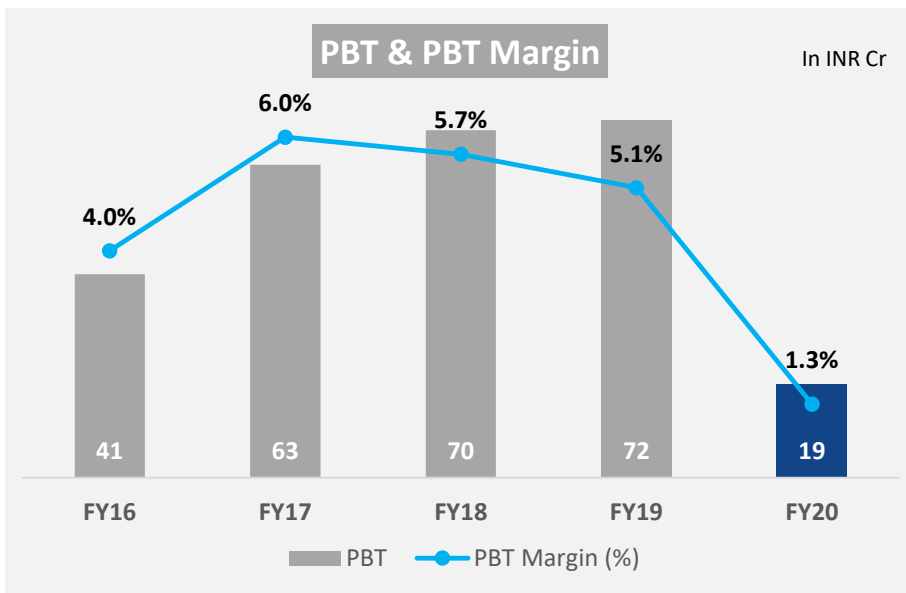
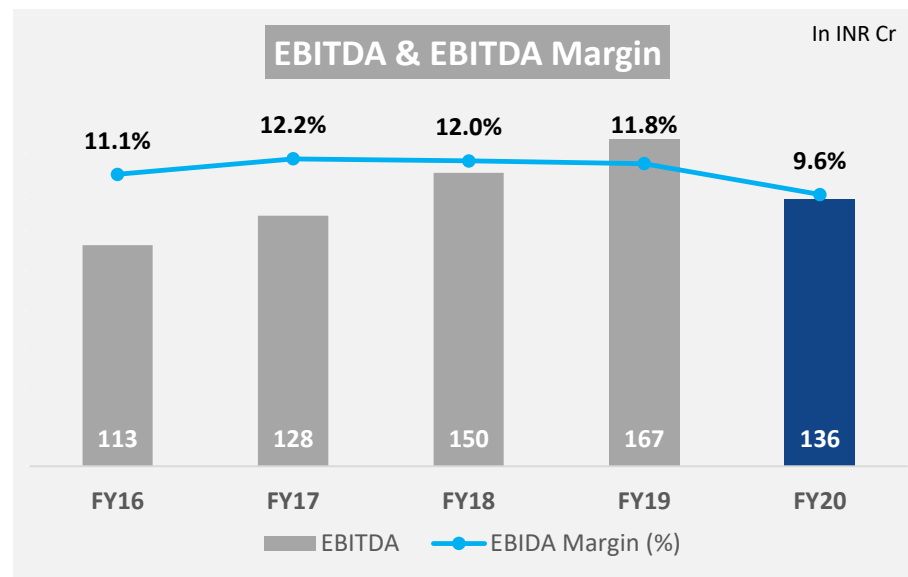
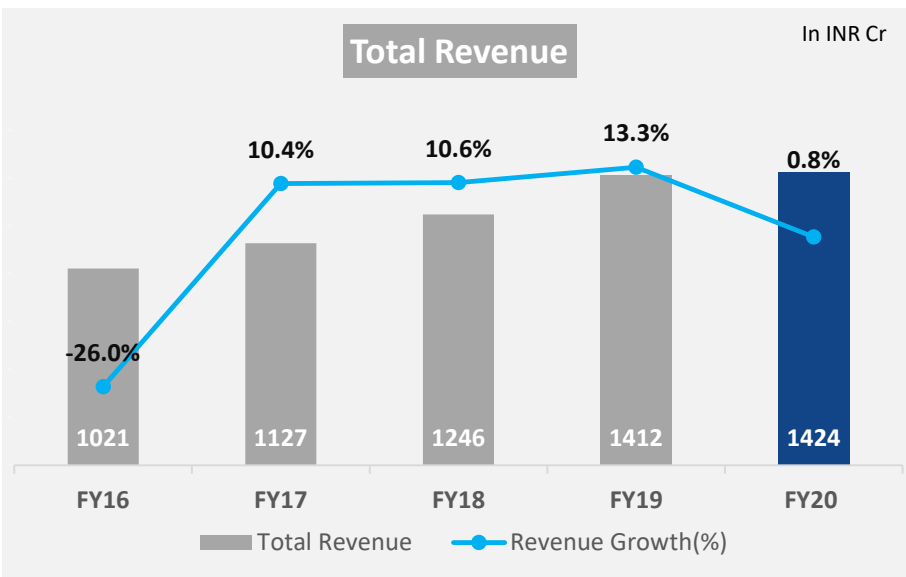

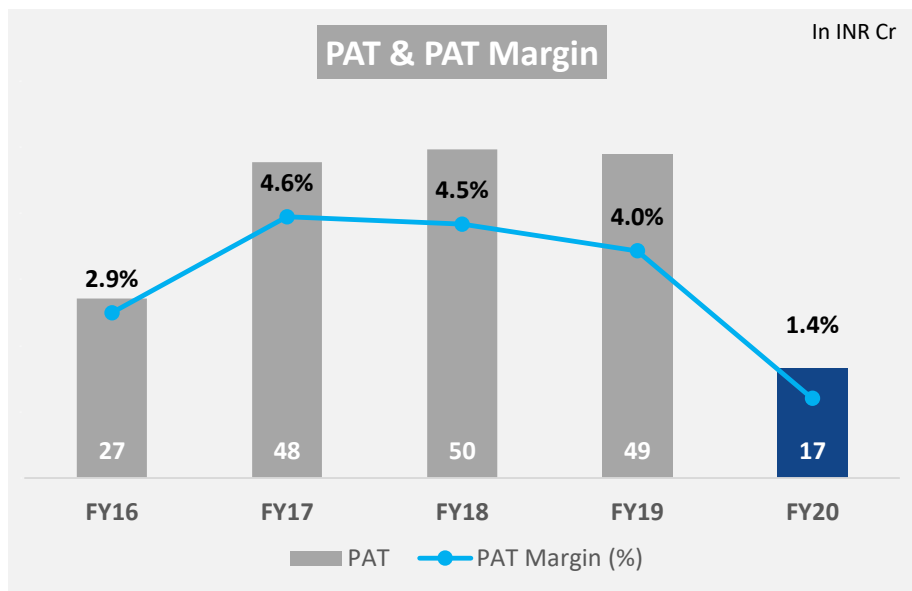
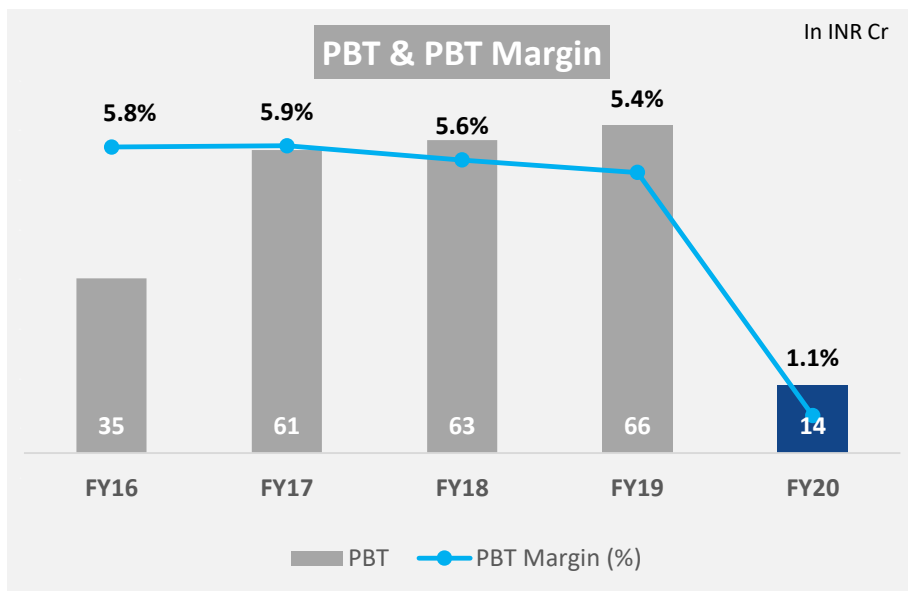
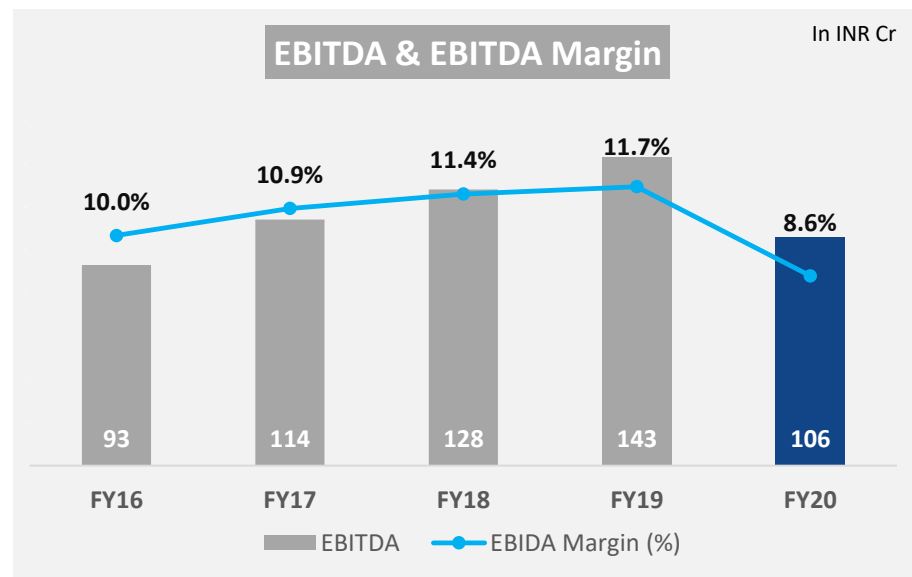
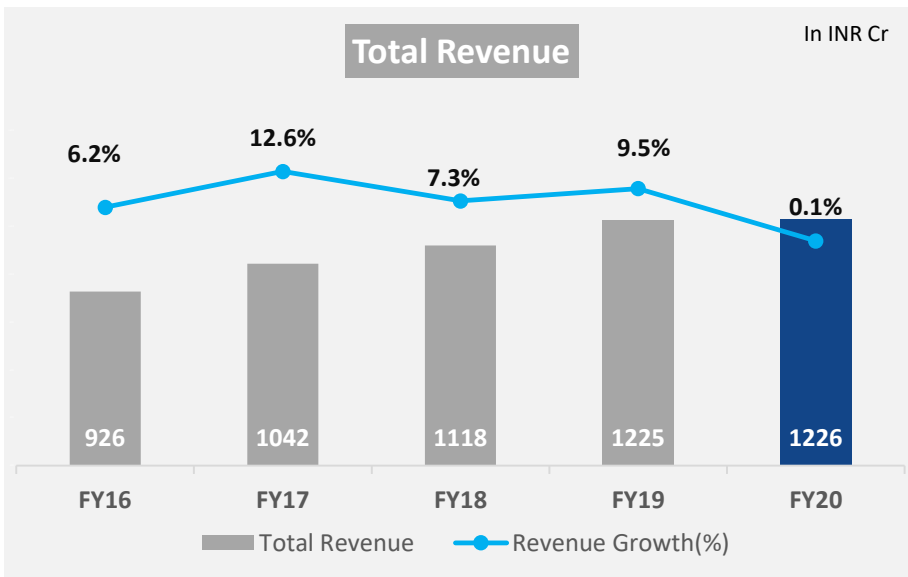

\*Annualized



## Shareholding Pattern (as on 31<sup>st</sup> March 2020)

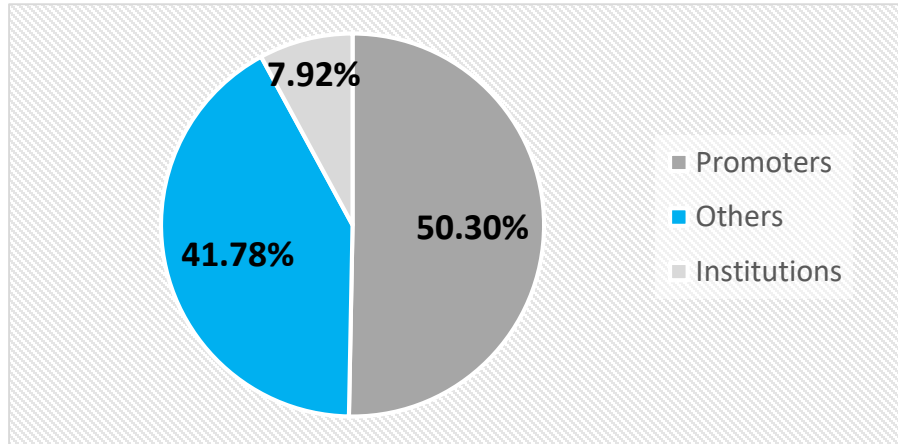

## Stock Data (as on 31<sup>st</sup> March 2020)

	Market Cap	269.21 Cr.
	Stock Price	₹ 19.9
	52 Week (High / Low)	₹ 72.65/16.8
	NSE / BSE - Symbol	RICOAUTO / 520008
	No. of Shares Outstanding	135,285,000
	Average Daily Volume (3Months) - NSE	183,926

## Stock Performance (as on 31<sup>st</sup> March 2020)

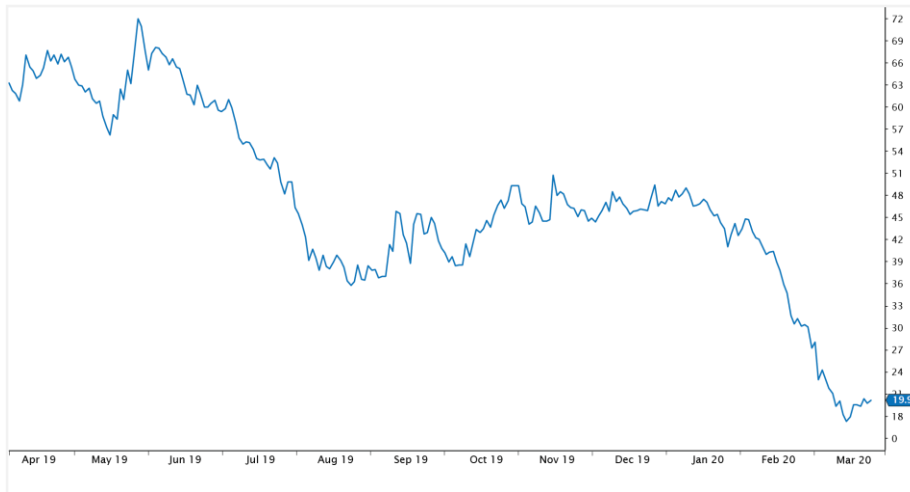

## Group-Wise Shareholding (as on 31<sup>st</sup> March 2020)

Name	# Share	% O/S
RELIANCE NIPPON	49,41,330	3.65
L&T MUTUAL FUND	35,22,882	2.60
Khandwala Family	22,41,990	1.56
Mukul Agrawal	20,00,000	1.48
Ashmore India Opportunities Fund	17,22,847	1.27



Thank You

## **RICO AUTO INDUSTRIES LIMITED**

38 KM Stone, Delhi - Jaipur Highway,  
Gurgaon - 122001, Haryana (INDIA)

**Phone:** +91 124 2824000 (B)

**E-mail:** [cs@ricoauto.in](mailto:cs@ricoauto.in)

**Website:** [www.ricoauto.in](http://www.ricoauto.in)

## **Investor Relations**

**Saurabh Bhawe**

**S-Ancial Technologies Pvt. Ltd.**

215, Shivshakti Industrial Estate, J.R Boricha  
Marg, Lower Parel (E) Mumbai-400011

**Phone:** +91 9821956992

**E-mail:** [saurabh@s-ancial.com](mailto:saurabh@s-ancial.com)

**Website:** [www.s-ancial.com](http://www.s-ancial.com)